

# **Four-Door Bidirectional Access Controller User's Manual**

**V1.0.0**

## Table of Contents

1 Overview .....	1
2 Device Appearance .....	2
3 Device Installation .....	4
4 System Cabling and Structure .....	5
4.1 Cabling .....	5
4.2 Structure .....	6
5 Technical Specification.....	7

## Important Safeguards and Warnings

Please read the following safeguards and warnings carefully before using the product in order to avoid damages losses and body injuries. After reading, please well keep this user's manual.

Note:

- Please change user default password after being armed.
- Do not install the device at position exposed to sunlight or in high temperature. Temperature rise in device may cause fire.
- Do not expose the device to lampblack, steam or dust. Otherwise it may cause fire or electric shock.
- The device must be installed on solid and flat surface in order to guarantee safety under load and earthquake. Otherwise, it may cause device to fall off or turnover.
- Do not drop or splash liquids onto the device, and do not place container with full liquid on the device to prevent liquid spilling from entering the device.
- Do not block air vent of the device or ventilation around the device. Otherwise, temperature in device will rise and may cause fire.
- Use the device only within rated input and output range.
- Do not disassemble the device without professional instruction.
- Please transport, use and store the product under appropriate temperature and humidity.

## Warning:

- Please use battery properly to avoid fire, explosion and other dangers.
- Please replace used battery with battery of the same type.
- Do not use power line other than the one specified. Please use it properly within rated range. Otherwise, it may cause fire or electric shock.
- Please use power supply matching SELV requirements, and IEC60950-1 Limited Power Source. Power supply shall follow requirements on device label.
- For I-type structure product, connect it to power supply plug with GND protection.
- If you use power plug or appliance coupler as disconnecting device, please maintain the disconnecting device available to be operated all the time.

## Special Announcement

- This manual is for reference only, subjected to the actual product.
- All the designs, software and instructions here are subject to change without prior written notice.
- All damaged and losses caused by operation not following instructions in this manual, are borne by the user.
- All trademarks and registered trademarks are the properties of their respective

owners.

- If there is any uncertainty or controversy, please refer to the final explanation of us.
- Please visit our website for more information.

# 1 Overview

The access controller is a controlling device which compensates video monitoring and bidirectional talk. It has neat and modern design with strong functionality, suitable for commercial building, corporation property and intelligent community.

It has:

- Industrial professional design with lock and hinge. It max load-bearing is 80kg under good vandal-proof design.
- It integrates alarm, access control, video monitoring, fire alarm and control module input.
- It supports 8 sets of card readers (may set 4 as bidirectional card readers, RS485 or wiegand input).
- It supports 4 groups of unlock button, 4 groups of door sensor, 4 groups of bolt feedback, 1 group of local vandal-proof.
- It supports 8 groups of external alarm input (with anti-cut function).
- It supports 4 groups of door lock control output.
- It supports 4 groups of external input signal, 4 groups of internal alarm output
- Audio module output (need external speaker).
- External GSM module.
- It supports 2 groups of RS485 port, may extend to connect to lift control module, alarm or home control module.
- FLASH storage capacity is 16M (may extend to 32M), max supports 100,000 card holders and 150,000 records.
- It supports vandal-proof alarm, illegal intrusion alarm, unlock overtime alarm, forced card alarm and forced setup. It also supports black-white list and patrol card setup
- It supports setup of card period, password and validity. Guest card in additional has setup of times of use.
- It supports 128 groups of schedules, 128 groups of periods and 128 groups of holiday schedule.
- Data storage during outage, built-in RTC (DST), online upgrading.

## 2 Device Appearance

Access controller appearance and dimension are shown in Figure 2- 1 Dimension 1 and Figure 2- 2 Dimension 2. Unit is mm.

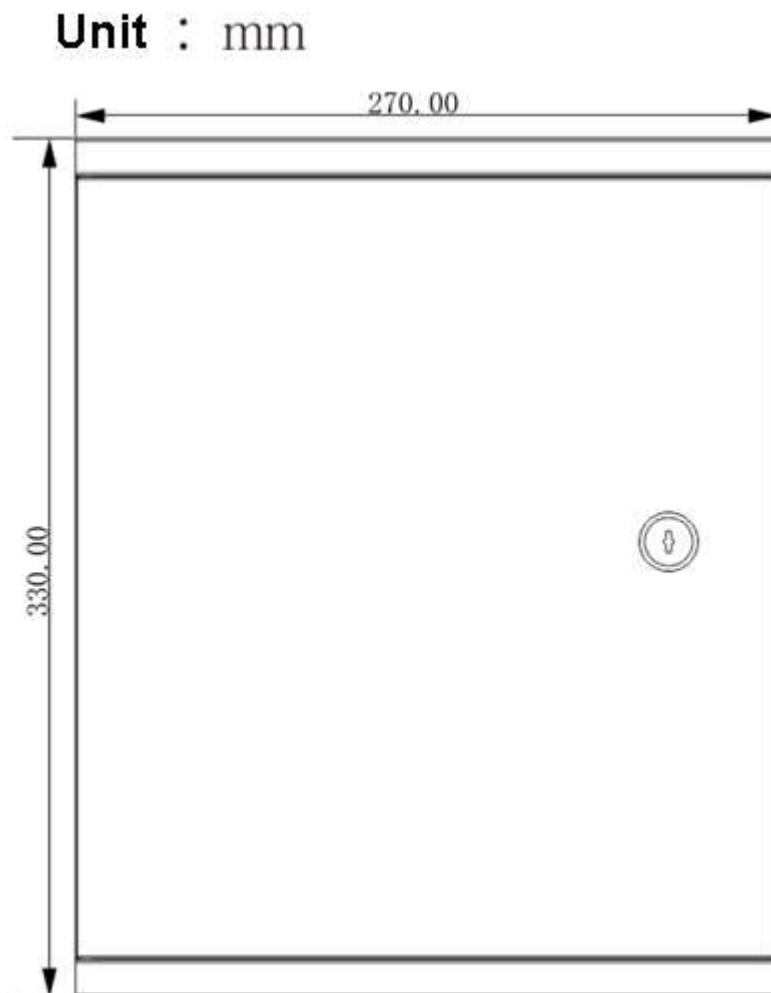

Figure 2- 1 Dimension 1

**Unit : mm**



Figure 2- 2 Dimension 2

### 3 Device Installation

Device installation is shown in Figure 3- 1.

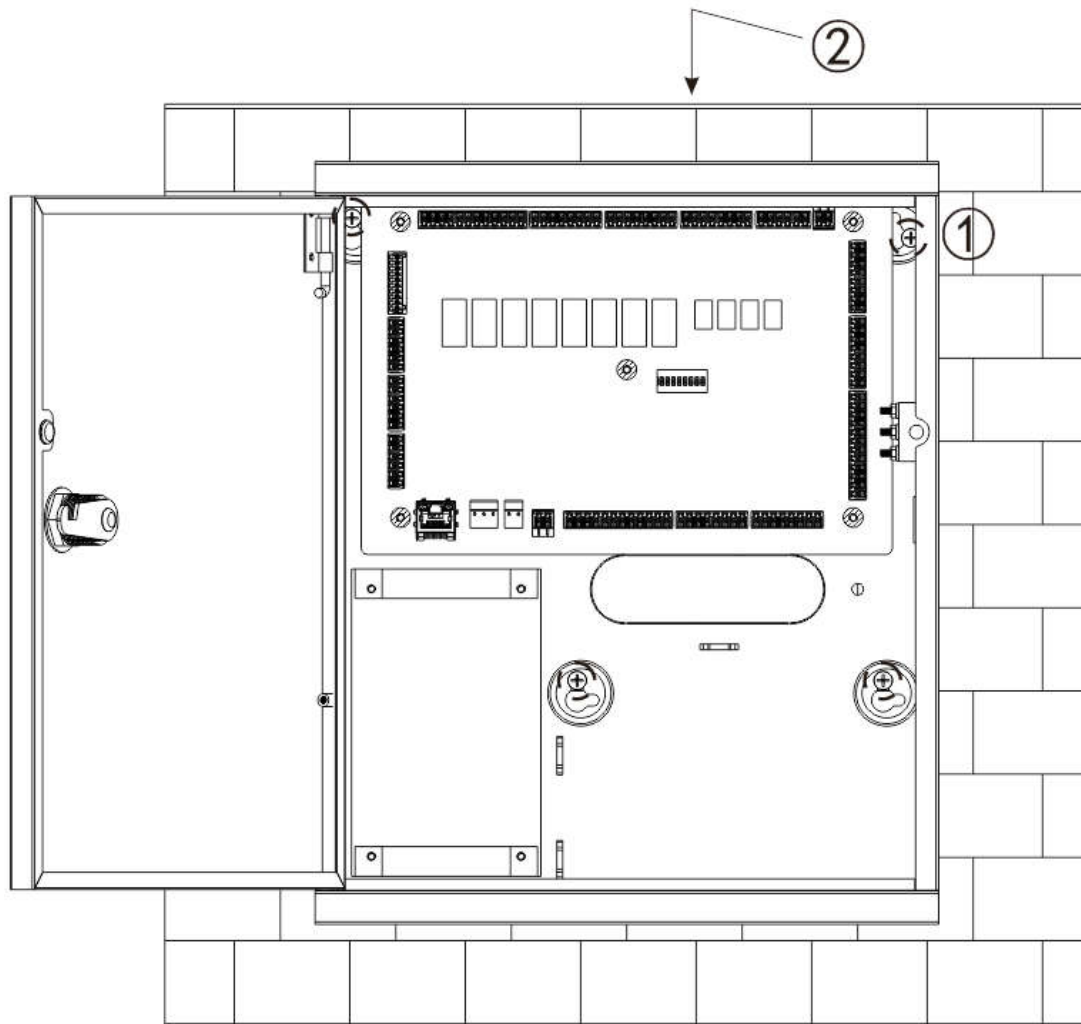

Figure 3- 1

Installation steps:

Step 1. Fix screw via expansion bolt to hang the device on wall according to the distance of holes at rear of device.

Step 2. Via screw fixed on wall to hang the device on wall.

# 4 System Cabling and Structure

## 4.1 Cabling

Device cabling is shown in Figure 4- 1.

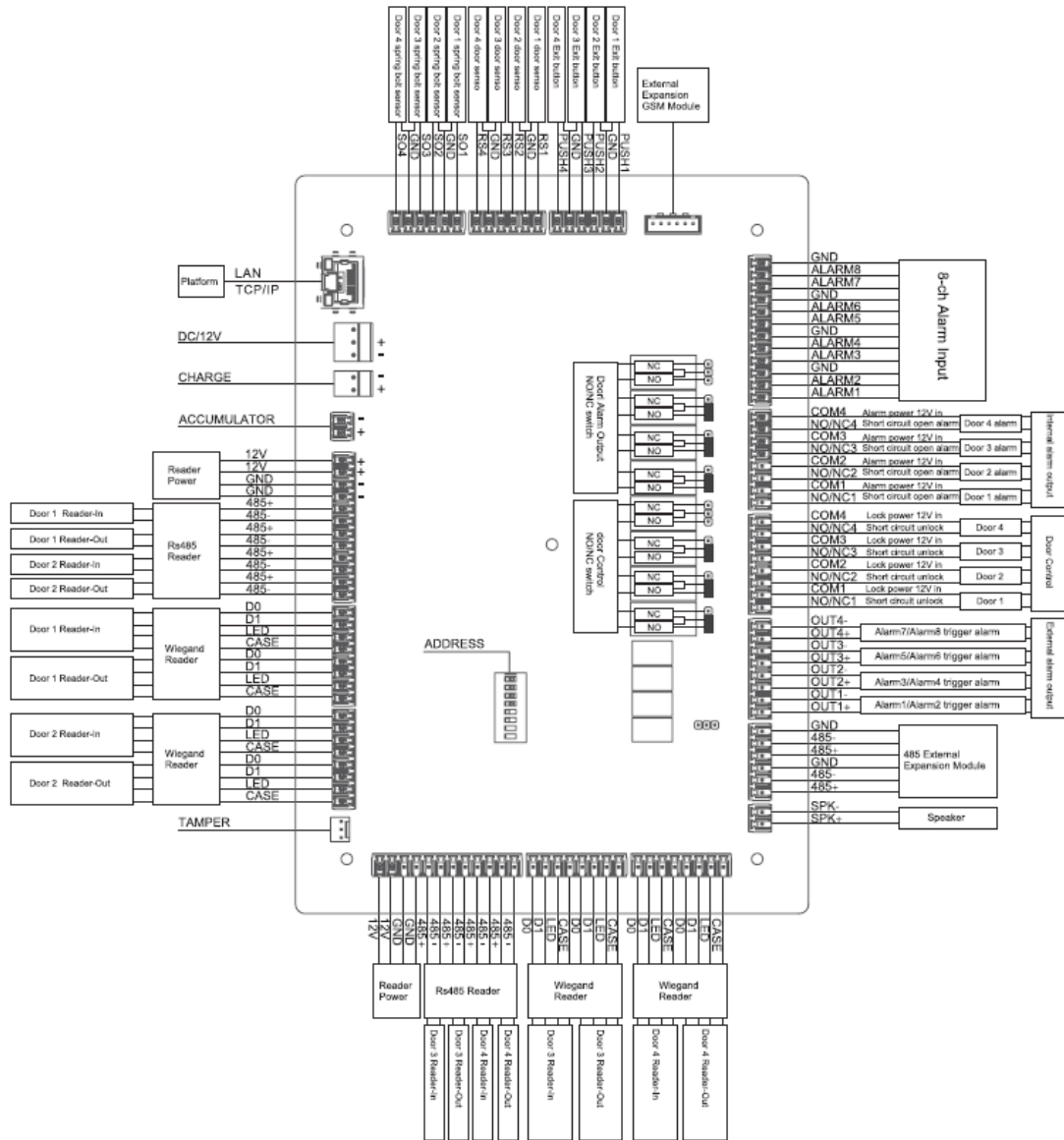

Figure 4- 1

## 4.2 Structure

Access controller, lock, card reader and etc. combine a system as in Figure 4- 2.

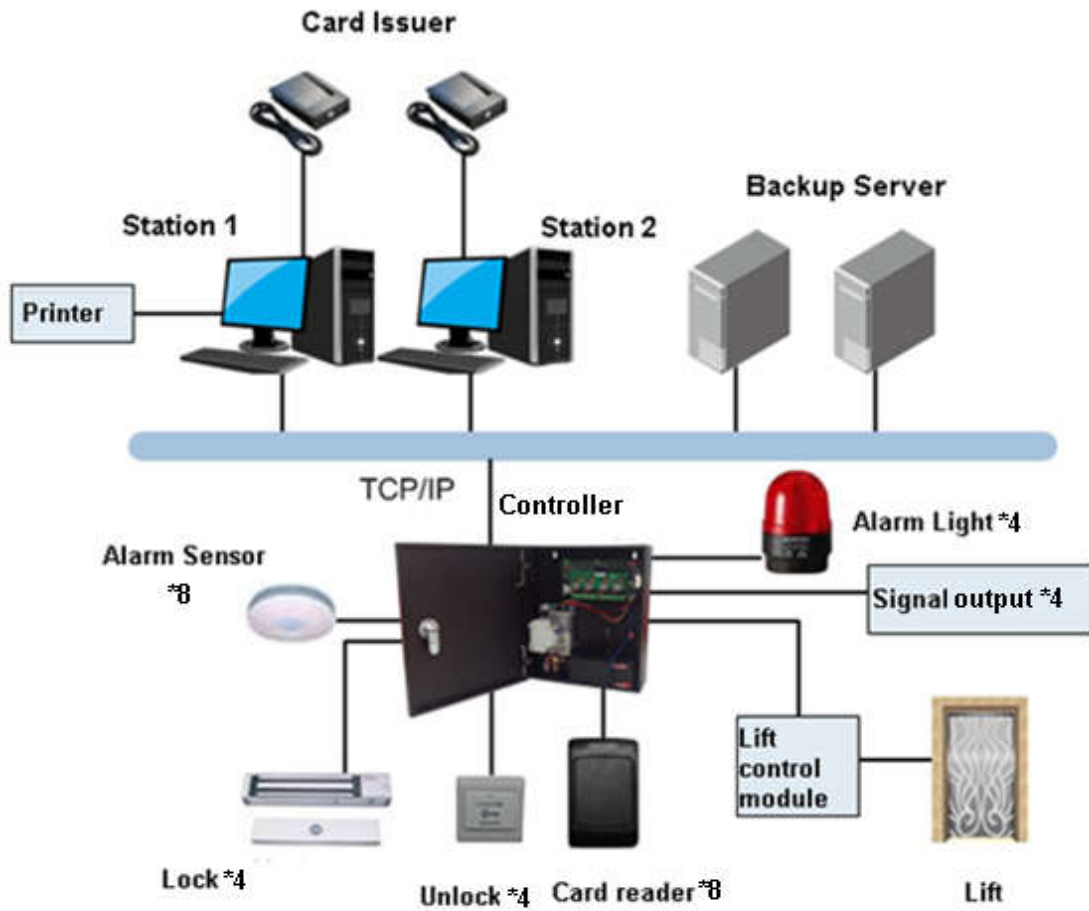

Figure 4- 2

## 5 Technical Specification

Parameter	Specification
Processor	32 bit ARM processor
Storage Capacity	16M
Max User	100,000
Max Record	150,000
Card Reader Communication Port	Wiegand, RS485
Platform Communication Port	TCP/IP
Input Card Reader Quantity	8 groups
Working Power	Rated power AC85-264V
Schedule	128
Period	128
Holiday	128
Unlock Mode	Card, card+password, password, card or password, card+fingerprint, fingerprint+password, fingerprint or card or password, by period.
Cross-Segment Network	Support
Dual-Door Lock	Support
Single-Door Bidirectional Swiping	Support
Real-Time Monitoring	Support
Alarm Activation	Support
Vandal-Proof Alarm	Support
Illegal Intrusion Alarm	Support
Unlock Overtime Alarm	Support
Forced Card And Password Setup	Support
DST And Time Sync	Support
Online Upgrading	Support

**Note:**

- **This manual is for reference only. Slight difference may be found in user interface.**
- **All the designs and software here are subject to change without prior written notice.**
- **All trademarks and registered trademarks are the properties of their respective owners.**
- **If there is any uncertainty or controversy, please refer to the final explanation of us.**
- **Please visit our website or contact your local service engineer for more information.**