

Previdia Compact

Analog addressable networkable fire detection control panel

Previdia Compact combines compactness with top-of-the-range features, its unique key feature provides an extremely simple to use and configure control panel which is at the same time powerful and flexible to adapt to any installation.

The use of an LCD graphic display provides clear and effective information reducing dramatically the reaction time in case of fire. The display can provide maps and (if connected to a IFMLAN of a Previdia Max control panel in a Hornet+) images from camera to provide to the user a complete control of the situation.

The system can be easily configured from the front panel or a powerful PC configuration software that is available to manage easily all those advanced functions available in the panel (logic equations, evacuation matrix, timers, actions, remote communicators etc.).



MAIN FEATURES

- Compact analog addressable fire control panel
- Two loops or single loop option
- Up to 240 devices per loop
- 4.3" graphic display, 65000 colours
- Touchscreen display
- Zones LED indicators available as an option
- One channel gas extinction function available as an option
- 1.5 A or 4 A power supply included
- Battery charger included
- Ethernet port with TCP-IP connection included
- USB port for configuration
- Micro SD card management for saving/loading configuration data
- Optional dialer module with PSTN / 3G / GSM voice and digital communicator, SMS facility, data connection
- Digital communicator included in the panel
- Certified CPR EN54-2, EN54-4 and EN54-13
- Certified CPR EN54-21 over all channels (IP/3G/GSM/PSTN)
- Certified EN12094-1 (fire extinguishing systems)
- Token ring network up to 48 panels, complete data and activations sharing, RS485 based
- Networking over TCP-IP, up to 20 panel clusters
- Video verification from any IP Onvif camera
- Multi protocol loop (Inim, Apollo and Argus devices supported)
- 4 Supervised power I/O channels available on board
- One relay available on board

TECHNICAL SPECIFICATIONS

Control panel models	in small cabinet		in large cabinet	
Supply voltage	115V~ (-15% / +10%) 50/60Hz	230V~ (-15% / +10%) 50/60Hz	115V~ (-15% / +10%) 50/60Hz	230V~ (-15% / +10%) 50/60Hz
Maximum current draw	1A	0.5 A	2.2A	1.1 A
Output voltage	from 18,5 to 27,8 V=			
Maximum output current	1,5 A		4 A	
Maximum battery-charge current	0.6A		1,2A	
Batteries	2 x 12 V, 7 Ah		2 x 12 V, 17 Ah	
Operating temperature	from -5°C to +40°C			
Protection grade	IP30			
Dimensions	322 x 324 x 86 mm		497 x 380 x 97 mm	
Weight	3.3 Kg		6.1 Kg	

Previdia Compact

FEATURES OF THE PREVIDIA/STUDIO SOFTWARE

- OpenLoop Technology
- LoopMap Technology
- Versa++ Technology
- Graphic map configuration
- Manages Modbus TCP protocol
- IP camera video-verification of alarms
- Manages SIA-IP protocol
- Possibility to send SMS messages with automatic text generation (with dialer module)
- Generates periodic reviews for the lighting and emergency lights in compliance with the regulations in force (CEI EN 50172 and UNI11222)
- Possibility to send up to 100 voice messages for a maximum of 8 minutes (with dialer module)
- Up to 240 devices per loop (depending on the selected protocol)
- Control equations for activations with logical operators (And, Or, Not, Xor, etc.)
- 1000 software zones per control panel
- 1000 logic groups each control panel
- 500 trigger activations each control panel
- 100 actions
- 240 logic group shareable in Hornet+ network or cluster
- Walk test function
- 2000 event memory
- Autoenrolling of loop devices
- Autoaddressing of loop devices
- Manages 4 access levels in accordance with EN54-2
- 4 password levels
- 100 user codes
- Programming software in Windows environment

DIMENSIONS

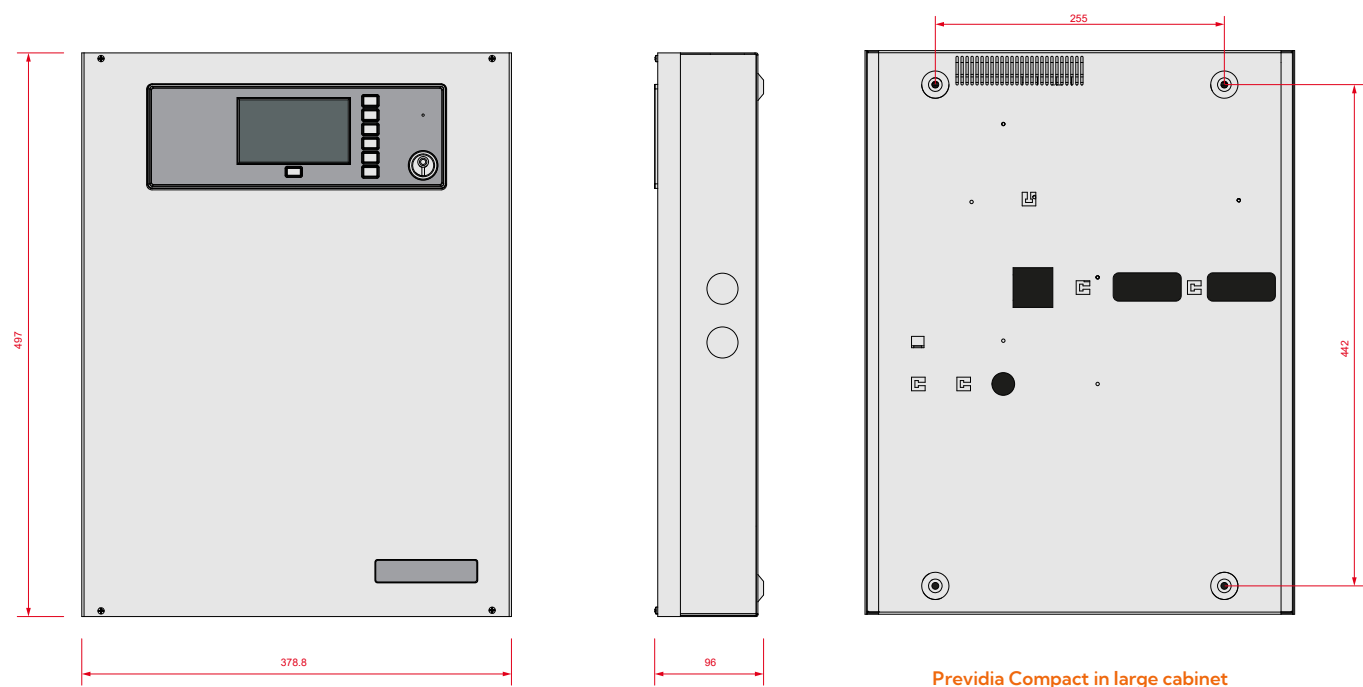
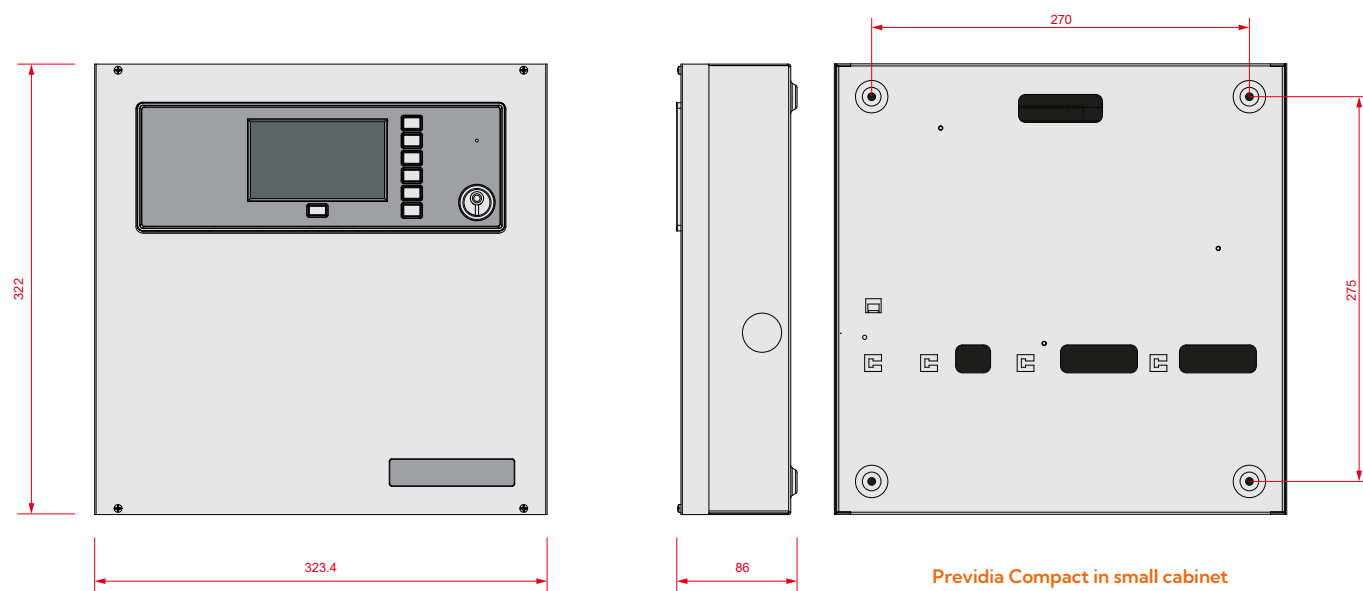

ACCESSORIES

The "S" version control panels (small cabinet) provide housing for 2 add-on modules (choice of Previdia-M-EXP, Previdia-C-DIAL, Previdia-C-COM and PREVIDIA-C-COM-LAN). The "L" version control panels (large cabinet) provide housing for a maximum of 4 modules.

PREVIDIA-C-DIAL

REMOTE COMMUNICATOR MODULE



Manages remote communications via wired telephone lines and 3G GSM networks. Capable of managing voice calls, recording up to 100 voice messages, SMS with automatic text generation and digital calls using the most widely used protocols.

TECHNICAL SPECIFICATIONS

Power supply voltage	19 / 30 V
Stand-by current draw	40mA
Maximum current draw	140mA
Band frequency	2G: 850/900, 1800/1900 MHz 3G: 800/850/900, 1900/2100 MHz
RF output power	2W, 1W
Operating temperature	-5° ... +40° C

PREVIDIA-C-COM / PREVIDIA-C-COM-LAN

SERIAL COMMUNICATIONS MANAGEMENT MODULE

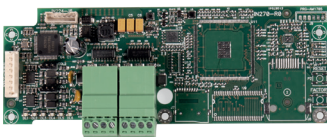

PREVIDIA-C-COM provides two RS232 ports and two RS485 ports for the connection of remote communicators, using the protocols available in the table.

COMMUNICATION PROTOCOL	RS232	RS485
ESPA444	✓	Protocol for interfacing with control panels to pagers, third-party remote communicators
PASO		✓ Protocol for interfacing between the control panel and the Voice EVAC-system
WEB WAY ONE	✓	Protocol for interfacing with WEB-WAY-ONE remote communicators
SMART-485-IN		✓ Communication protocol with the Inim SMART-485-IN module which allows connection to the standard interface panels required in some countries
LOG ON SERIAL – ASCII PRINTER	✓	Sends events to the port in real time in ASCII format (to a printer or receiving devices)
LOG ON SERIAL – SMART LOOP FORMAT	✓	Sends events to the port in real time in the format used by SmartLoop series control panels
LOG ON SERIAL – PLUS II PRINTER FORMAT	✓	It sends events to the port in real time in compatible format for Custom PLUSII printers
LOG ON SERIAL – WITHOUT CONTROLS	✓	Sends events to the port in real time in ASCII format without any control for the printers

PREVIDIA-C-COM-LAN provides, in addition, a socket for connection to the Ethernet network for advanced TCP-IP functions such as sending e-mails, an interactive Web page with graphic maps, video verification via connection to IP cameras with ONVIF protocol, BACnet protocol (subject to PRE-BACLIC) and interfacing with TUTONDO EVAC systems (via TCP-IP).

TECHNICAL SPECIFICATIONS

Power supply voltage	19 / 30 V
Current draw	40 mA
RS485 maximum current draw	200mA
SD card capacity	32 GB (PREVIDIA-C-COM LAN only)
Operating temperature	-5° ... +40° C

ACCESSORIES

PREVIDIA-C-REP / PREVIDIA-C-REPE

REMOTE CONTROL KEYPAD (REPEATER)



PREVIDIA-C-REP with customizable 4.3" touchscreen LCD, buttons for basic functions and status LEDs. Connects to the HORNET+ network (dual RS485 connection) or via ETHERNET TCP-IP network. It provides detailed information about the entire network. Internal buzzer. Level 2 via key or code.

PREVIDIA-C-REPE provides, in addition, indication relating to the extinguishing channel.

TECHNICAL SPECIFICATIONS

Power supply voltage	19 / 30 V
Stand-by current draw	110mA
Current draw during mains failure	80mA
Maximum current draw	130mA
Operating temperature	-5° ... +40° C
Weight	330 g

ORDER CODES

PREVIDIA-C050SG	Control panel with single loop limited to 64 devices, small cabinet, grey color
PREVIDIA-C050SZG	Control panel with single loop limited to 64 devices, small cabinet, zone LED indicators, grey color
PREVIDIA-C050SZEG	Control panel with single loop limited to 64 devices, small cabinet, zone LED indicators, extinction channel, grey color
PREVIDIA-C050LG	Control panel with single loop limited to 64 devices, large cabinet, grey color
PREVIDIA-C050LR	Control panel with single loop limited to 64 devices, large cabinet, red color
PREVIDIA-C100SG	Control panel with single loop, small cabinet, grey color
PREVIDIA-C100SZG	Control panel with single loop, small cabinet, zone LED indicators, grey color
PREVIDIA-C100SZEG	Control panel with single loop, small cabinet, zone LED indicators, extinction channel, grey color
PREVIDIA-C100LG	Control panel with single loop, large cabinet, grey color
PREVIDIA-C100LR	Control panel with single loop, large cabinet, red color
PREVIDIA-C200SG	Control panel with 2 loops, small cabinet, grey color
PREVIDIA-C200SZG	Control panel with 2 loops, small cabinet, zone LED indicators, grey color
PREVIDIA-C200SZEG	Control panel with 2 loops, small cabinet, zone LED indicators, extinction channel, grey color
PREVIDIA-C200LG	Control panel with 2 loops, large cabinet, grey color
PREVIDIA-C200LZG	Control panel with 2 loops, large cabinet, zone LED indicators, grey color
PREVIDIA-C200LZEG	Control panel with 2 loops, large cabinet, zone LED indicators, extinction channel, grey color
PREVIDIA-C050SR	Control panel with single loop limited to 64 devices, small cabinet, red color
PREVIDIA-C050SZR	Control panel with single loop limited to 64 devices, small cabinet, zone LED indicators, red color
PREVIDIA-C050SZER	Control panel with single loop limited to 64 devices, small cabinet, zone LED indicators, extinction channel, red color
PREVIDIA-C100SR	Control panel with single loop, small cabinet, red color
PREVIDIA-C100SZR	Control panel with single loop, small cabinet, zone LED indicators, red color
PREVIDIA-C100SZER	Control panel with single loop, small cabinet, zone LED indicators, extinction channel, red color
PREVIDIA-C200SR	Control panel with 2 loops, small cabinet, red color
PREVIDIA-C200SZR	Control panel with 2 loops, small cabinet, zone LED indicators, red color
PREVIDIA-C200SZER	Control panel with 2 loops, small cabinet, zone LED indicators, extinction channel, red color
PREVIDIA-C200LR	Control panel with 2 loops, large cabinet, red color
PREVIDIA-C200LZR	Control panel with 2 loops, large cabinet, zone LED indicators, red color
PREVIDIA-C200LZER	Control panel with 2 loops, large cabinet, zone LED indicators, extinction channel, red color
PREVIDIA-C-DIAL	Remote communicator module
PREVIDIA-C-COM	Serial communications management module
PREVIDIA-C-COM-LAN	Serial communications management module and advanced TCP-IP functions
PREVIDIA-C-REP	Remote control keypad (repeater)
PREVIDIA-C-REPW	Remote control keypad (repeater). Enclosure in white plastic
PREVIDIA-C-REPR	Remote control keypad (repeater). Enclosure in red plastic
PREVIDIA-C-REPE	Remote control keypad (repeater) with indications relative to an extinguishing channel
PREVIDIA-C-REPEW	Remote control keypad (repeater) with indications relative to an extinguishing channel. Enclosure in red plastic
PREVIDIA-C-REPER	Remote control keypad (repeater) with indications relative to an extinguishing channel. Enclosure in white plastic